

SILENTIUM PM 43Re HOTEL

Door with wood coated sheets, double leaf, prepared to receive a hotel lock, without rim in the pavement and cut-fire.

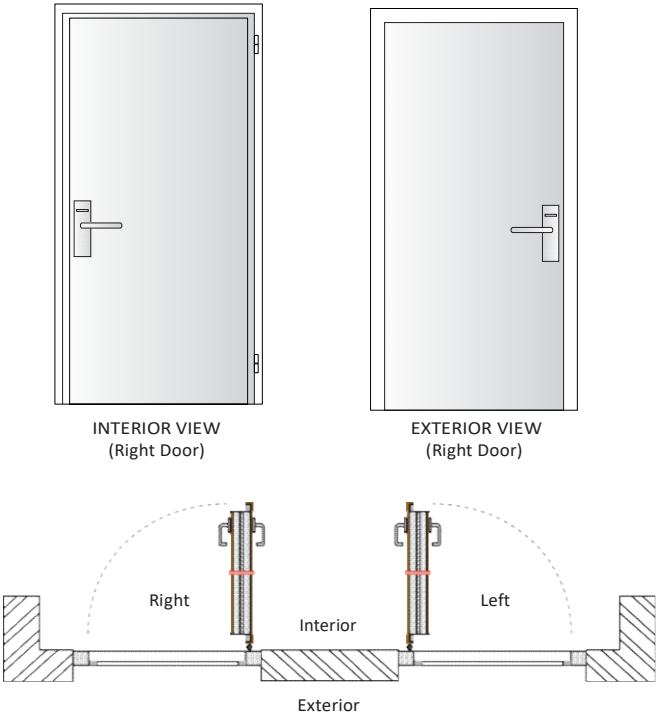

1 Sheet Door



STANDARD Model	FREE PASSAGE MEASURES	EXTERIOR DOOR MEASURES	RECOMMENDED MEASURES FOR THE CONSTRUCTION SPAN	WEIGHT (Kg)
	L x A (mm)	L x A (mm)	L x A (mm)	
SILENTIUM PM 43Re-1/800 - Hotel	800 x 2000	970 x 2085	975 x 2090	90
SILENTIUM PM 43Re-1/850 - Hotel	850 x 2000	1020 x 2085	1025 x 2090	94
SILENTIUM PM 43Re-1/900 - Hotel	900 x 2000	1070 x 2085	1075 x 2090	98

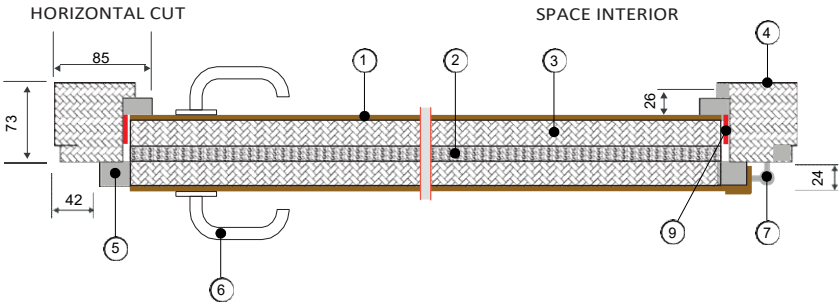

- 1 - Wood coating over steel sheet
- 2 - Heavy Core
- 3 - Panel in very absorbing plate
- 4 - Pre-Rim and metallic rim with absorbent interior
- 5 - Sealant in special profile

- 6 - Handle of the latching system (supplied by the client)
- 7 - Adequated hinge to the weight of the door, allowing a 180° rotation
- 8 - Mechanic system of the windowsill seal
- 9 - Intumescent Joint

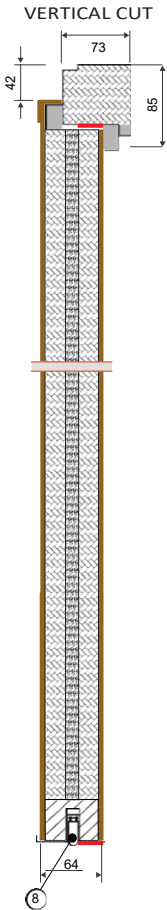

CHARACTERISTICS

Acoustic door with wood coated sheets with 64 mm of thickness, including the rim all around the edge, with double sealant in special profile all around the surrounding, being next to the pavement with mechanic system / mobile sill.

Constituted by a heavy core and two absorbing chambers totally filled with absorbent and dampening material.

It includes manufacturer preparation to receive a cardboard lock, typical in hotels – for that effect, the design and a physical sample of the pretended lock shall be previously supplied.

TYPICAL APPLICATIONS

Hotel room entrances and similar. In a general way spaces where high levels of acoustic isolation are pretended.

THICKNESS: 64 mm.

Resistance to fire: EI2 30 - certificate AFITI / LICO nr.8176/09-2

Acoustic isolation: Rw = 46 dB - Test LAIC 8-133/05

ACESSORIES/POSSIBLE OPTIONS (UNDER CONSULTATION):

Visit glasses, springs and other coating of wood or high pressure laminates.

SUPERFICIAL STANDARD TREATMENT:

Sheets with standard gamma of wood coating (Pine, Mahogany, Sucupira, Izombé, Kambala, Beech or Oak), with pore sealant or a white primary to posterior lacquer.

Lacquered Brown chocolate color Rim, RAL 8017

